

Dickinson College }  
No 754.

No. 2584.

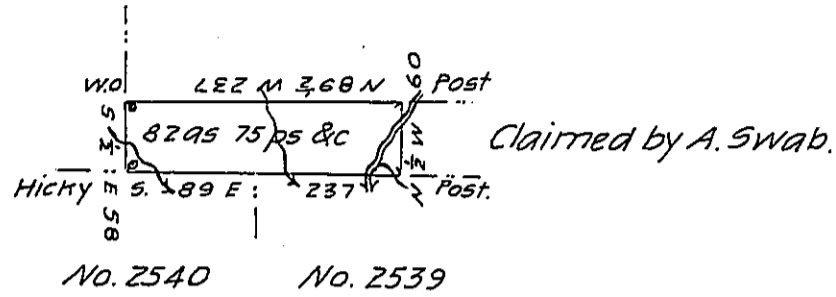

Draft of a tract of land situate in Pinegrove township, Venango county, East of the Allegheny River, on the waters of East Sandy Creek.

Surveyed 1st May 1839, in pursuance of a warrant granted to John G. Oppenlander, dated 13th March 1838

Richd Irwin D.S.

John Taylor Esqr.

Surveyor General of Pa.

IN TESTIMONY that the above is a copy of the original remaining on file in the Department of Internal Affairs of Pennsylvania, made conformably to an Act of Assembly approved the 16th day of February, 1833, I have hereunto set my Hand and caused the Seal of said Department to be affixed at Harrisburg, this sixteenth day of April 1906

*Loacn Brown*  
Secretary of Internal Affairs.